

QAV-PRO VIER

PROFESSIONAL EQUIPMENT FOR CINEMATIC FPV



PRODUCT MANUAL



PARTS NEEDED FOR THE ASSEMBLY

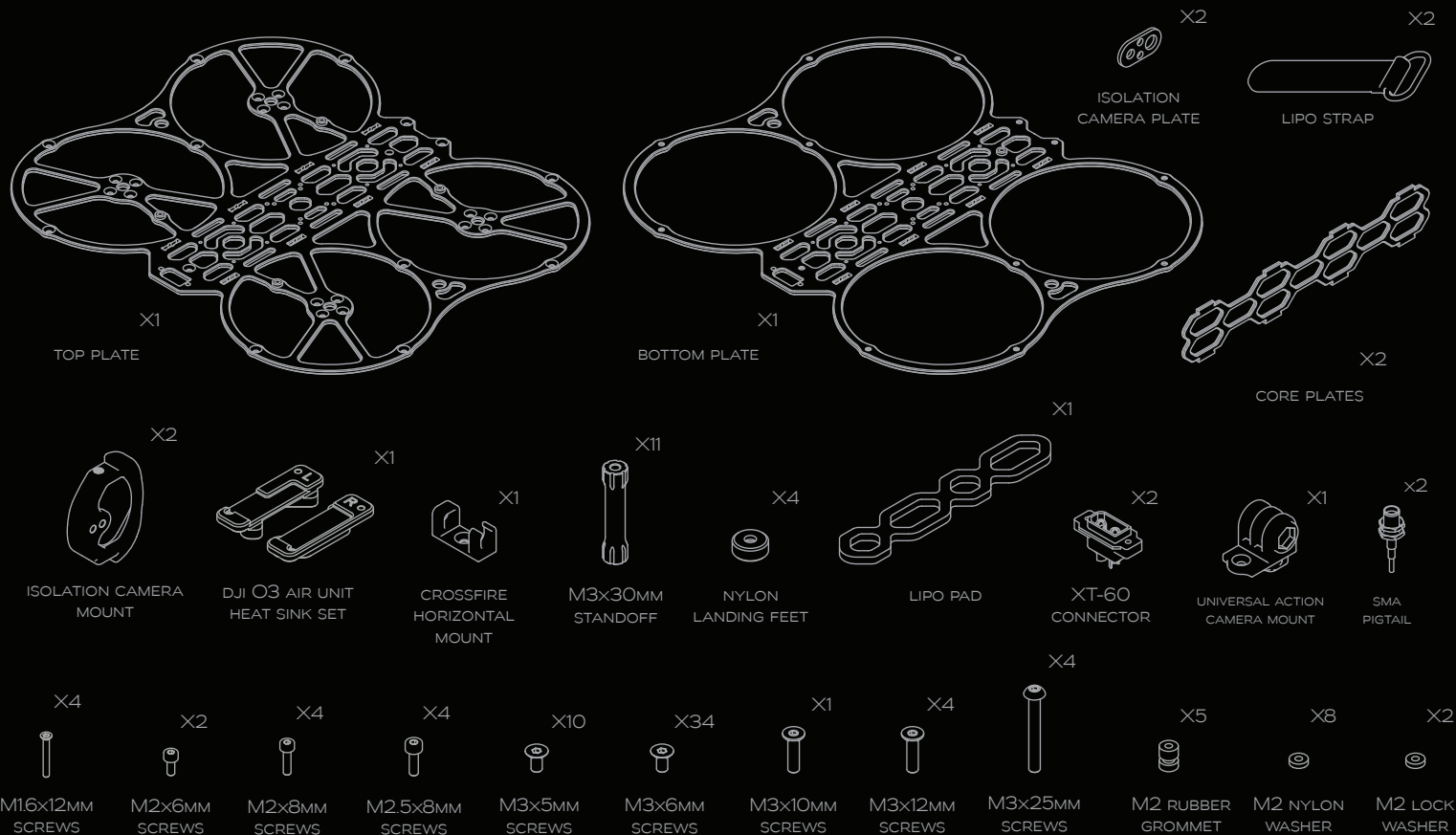

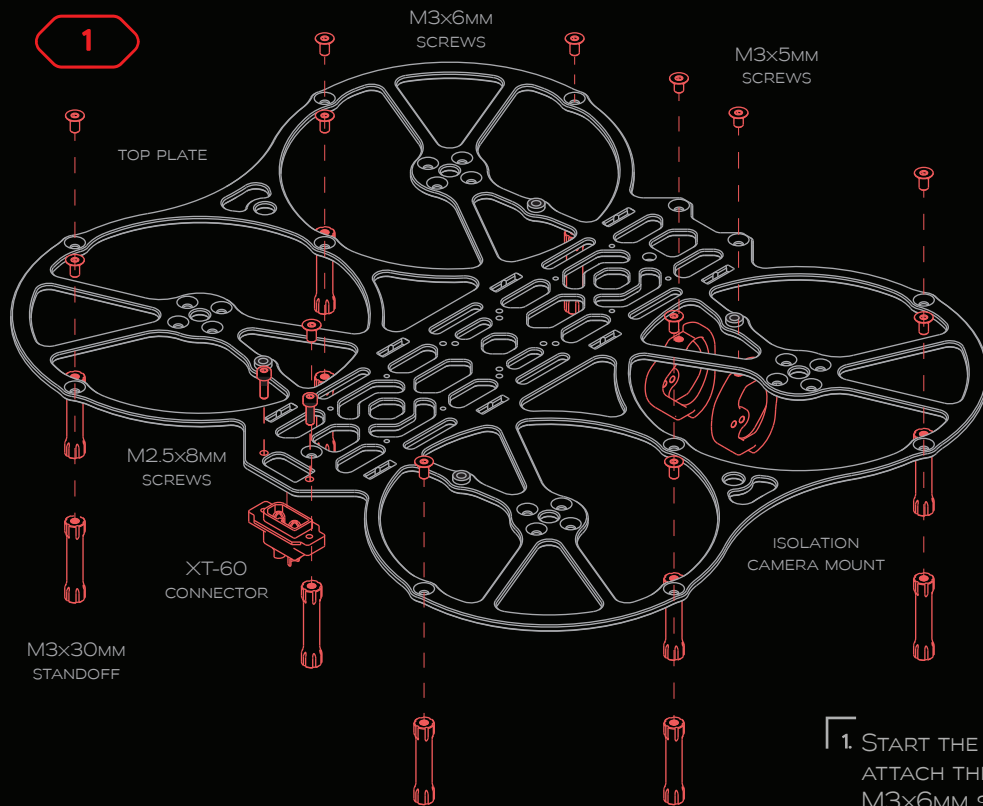

TOP PLATE ASSEMBLY

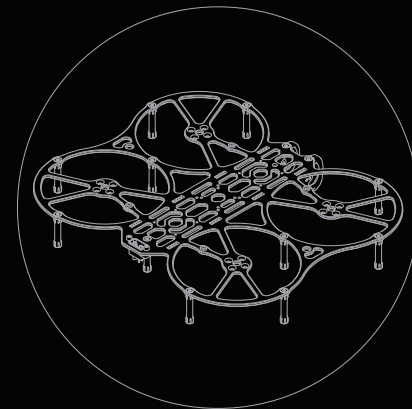

1. START THE ASSEMBLY BY USING THE BOTTOM PLATE TO ATTACH THE M3x30MM STANDOFFS WITH THE M3x6MM SCREWS AND THE M3x5MM SCREWS TO MOUNT THE ISOLATION CAMERA MOUNT ON THE FRONT.

INSTALL THE XT-60 MOUNT ON THE REAR USING THE M2.5x8MM SCREWS.

2

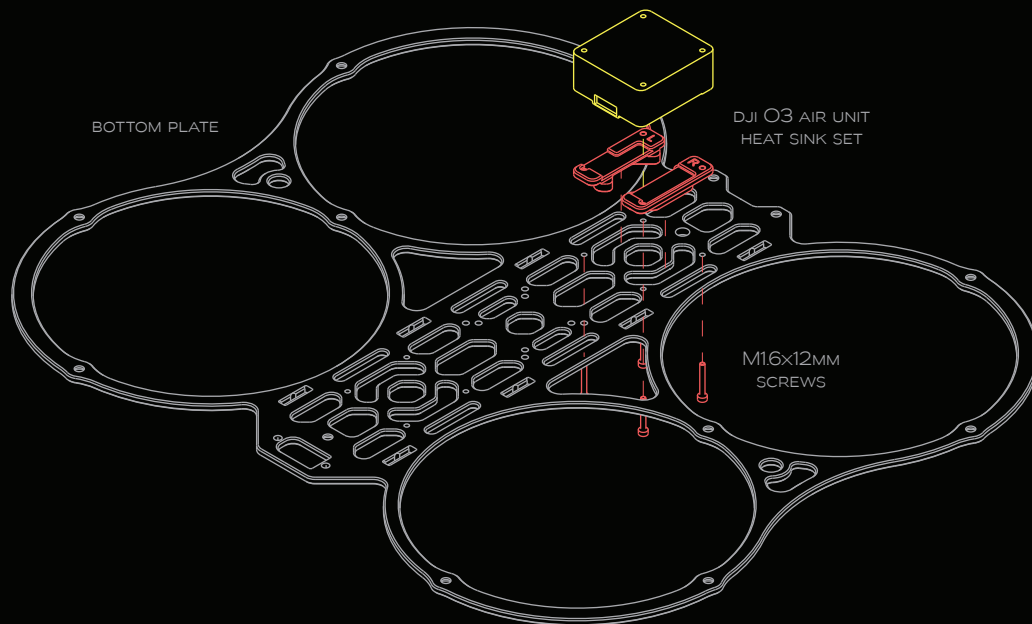

BOTTOM PLATE ASSEMBLY

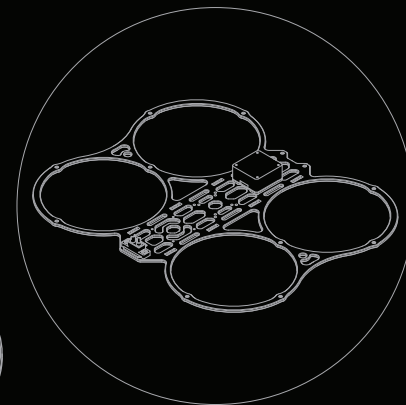

2. USE THE BOTTOM PLATE TO MOUNT THE DJI O3
MODULE IN THE FRONT 25x25MM
PATTERN.

SECURE THE MODULE TO THE HEAT SINK
PLATES BY USING THE M16x12MM
SCREWS.

3

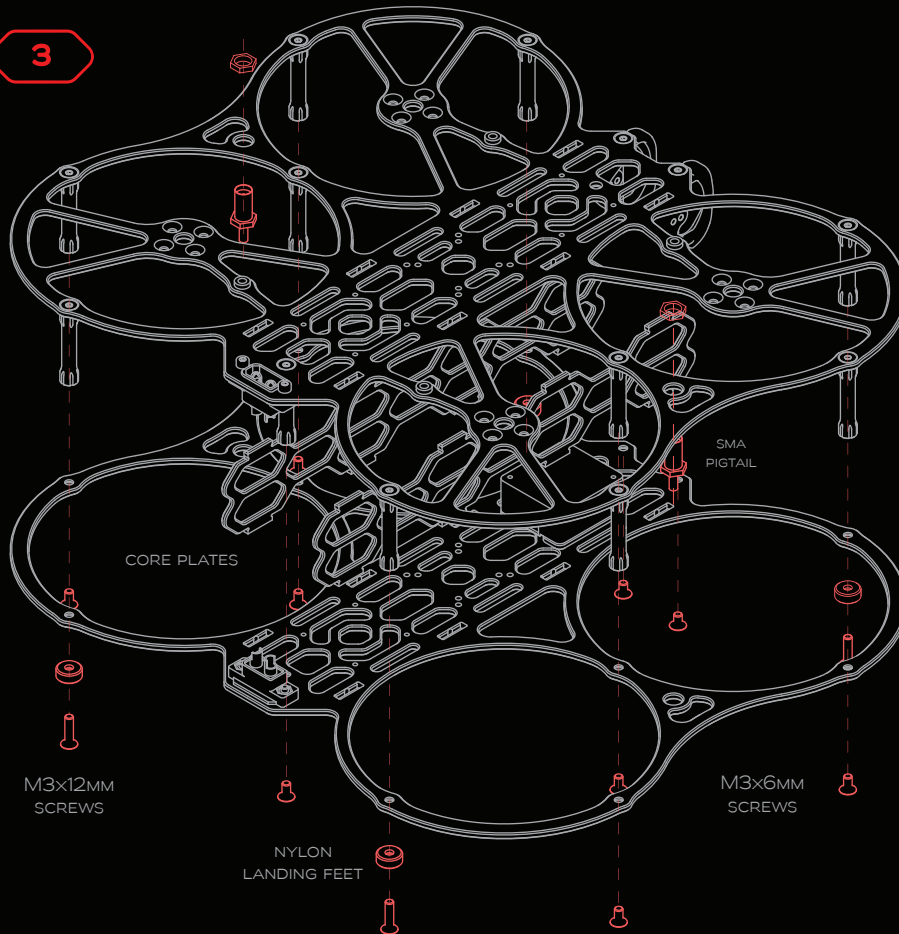

CLOSING THE ASSEMBLY

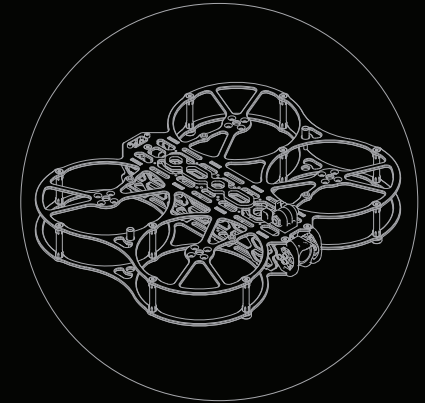

3. CLOSE THE FRAME BY INSTALLING THE CORE PLATES IN THE TABS AND SECURE THE TOP AND BOTTOM ASSEMBLIES AND THE M3x6MM SCREWS.

IN ORDER TO ADD THE NYLON LANDING FEET USE THE M3x12MM SCREWS TO SECURE THEM TO THE BOTTOM PLATE.

MOUNT THE SMA PIGTAIL IN THE TOP PLATE HOLES AND SECURE THEM.

4

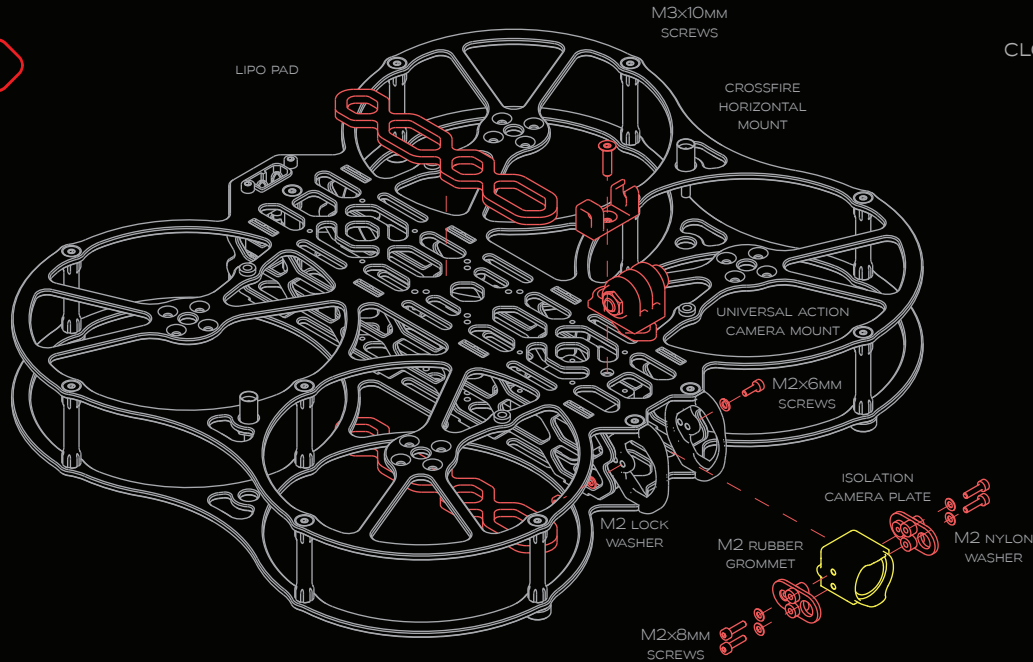

CLOSING THE ASSEMBLY

4. FINISH THE BUILD BY ADDING THE ACCESSORIES AND MISCELANEOUS PARTS SUCH AS THE LIPO PAD. USE THE M3x10MM SCREW TO SECURE THE CROSSFIRE HORIZONTAL MOUNT TOGETHER WITH THE UNIVERSAL ACTION CAMERA MOUNT.

USE THE ISOLATION CAMERA PLATE, M2 RUBBER GROMMET, M2 NYLON WASHER AND M2x8MM SCREWS TO FINISH THE FPV CAMERA ASSEMBLY THAT WILL BE MOUNTED TO THE ALUMINUM CAMERA PLATES USING M2x6MM SCREWS AND M2 LOCK WASHERS.